

PKHR Heat Recovery Y-Branch Pipe Kit

These kits provide the necessary Y-Branch fittings, couplings, reducers, and/or caps to field erect a VRF refrigerant tubing system by means of permanent mechanical connection. Each kit is custom built to match the project system selection layout as provided by the customer. The couplings and reducers are shipped loose for field installation on to the respective Y-Branches. Refer to RCS installation instructions for details prior to installation.

*The copper Y-Branch center fittings are not UL Listed component.

Application	High Pressure HVAC/R
Max Rated Pressure	600 psi
Compatible Tubing	Seamless Copper Tubing, Drawn H58, Light Drawn H55, or Annealed O60 made to ASTM B280 and ASTM B75 Standard.
Agency Approval	ETL Listed 5011885. Conforms to UL 207 STD. Certified to CSA STD C22.2#140.3
Refrigerants	All CFC, HCFC, HFC, HFO, and class A2L refrigerants and refrigeration oils. The product is suitable for use with R744 (CO ₂) when used within the design pressure rating. The product is not suitable for use with ammonia, methyl chloride, hazardous or flammable refrigerants from Group 2 or 3 per ASHRAE 15.
Installation	The fittings must be installed per RCS installation instructions by skilled installers, trained specifically in the application and installation of RCS fittings. Contact RCS, Inc. for alternative tube support inserts when installing fittings on annealed copper coils or pre-insulated line sets with tube wall thicknesses less than specified by ASTM B280. Do not use on annealed copper sizes larger than 5/8" O.D.

KIT NUMBER	LIQUID	LP-GAS	HP-GAS
PKHRE14	YDP-030303	YDP-050504	YDP-060605
PKHRE16	YDP-030303	YDP-050504	YDP-050504
PKHRE22	YDP-030303	YDP-060605	YDP-050504
PKHRF28	YDP-030303	YDP-060605	YDP-060605
PKHRF33	YDP-030303	YDP-060605	YDP-060605
PKHRF45	YDP-050504	YDP-090907	YDP-060605
PKHRF56	YDP-050504	YDP-090907	YDP-060605
PKHRG71	YDP-060605	YDP-090906	YDP-090907
PKHRG72	YDP-050504	YDP-090906	YDP-060605
PKHRD73	YDP-060605	YDP-111109	YDP-090906
PKHRD90	YDP-060605	YDP-111109	YDP-090907
PKHRD145	YDP-060605	YDP-111109	YDP-090909

In a continuing effort to offer the best product possible, we reserve the right to change, without notice, specifications, and/or materials. Technical specification sheets appearing on refcouplingsys.com are the most recent data available.

Assembly Guide

Tube surface must be clean, free from scratches or any surface imperfections, and de-burred inside and out.

Place tube support INSERT in to clean and de-burred tube.

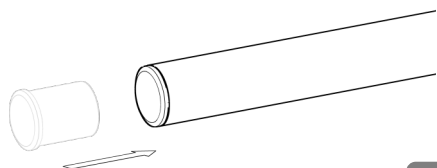

1

Place Fitting onto Tube with INSERT until TUBE/INSERT contacts the inner stop.

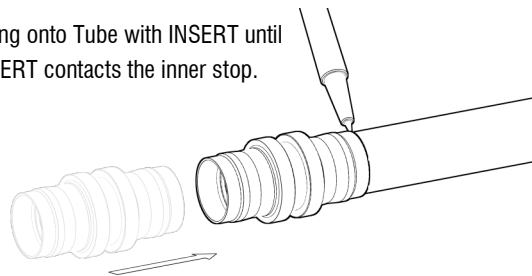

Mark Tube at end of FITTING with permanent felt tip marker.

2

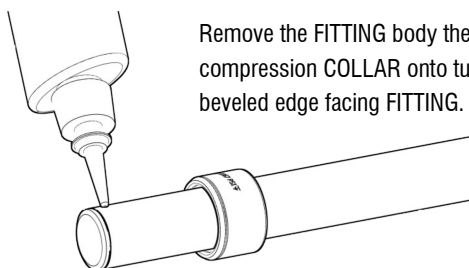

Remove the FITTING body then slide the compression COLLAR onto tube with the beveled edge facing FITTING.

Apply LocTite® to full circumference of tube end. Keep LocTite® 1/8" from end of TUBE and INSERT.

3

Slide the FITTING body back onto the TUBE with INSERT in place until TUBE/INSERT contacts the fitting inner stop.

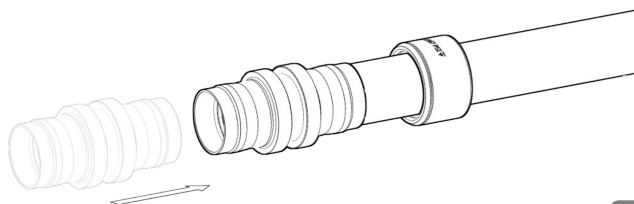

4

Keeping the TUBE/INSERT against the FITTING inner stop, slide the COLLAR against the FITTING. Collar should overlap the FITTING body.

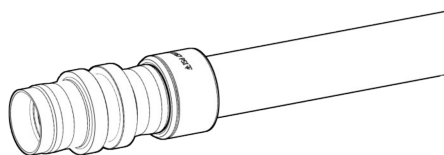

5

Place the FITTING and COLLAR into correct size press clamps. The assembly MUST be fully seated on the lower circumference of the clamps. Do not change the insertion depth of the TUBE/INSERT and the connecting joint.

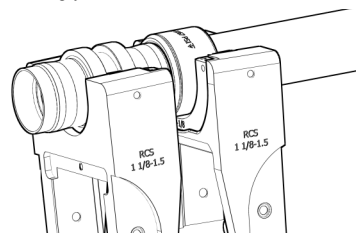

6

Using the press tool, press the COLLAR onto the FITTING body until it is fully seated against FITTING stop. TUBE/INSERT must be maintained against the FITTING inner stop during the pressing operation.

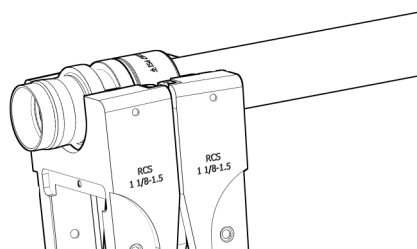

7



That the tube insert depth reference mark is visible and closely aligned with the end of the FITTING body.



That the COLLAR is in the correct orientation, fully seated, and is flush against the shoulder of the FITTING body.



That any gap between the COLLAR and the FITTING shoulders are less than 1mm.

8